

RIL

Intune Configuration

iOS

23rd November 2018

1. Introduction

Microsoft Intune is a Mobile Device Management (MDM) & Mobile Application Management (MAM) solution which helps to prevent leakage of corporate data from Mobile.

2. Pre-Requisite

Mobile Platform supported,

- ❖ **Apple** : 9.0 and later
- ❖ **Android** : 5.0 and later

Note: You can get Mobile OS details in **Security** → **System** → **About**

3. Enroll your device in Intune.

- Install the Microsoft Intune Company Portal app on your device from App Store and Click on Open.

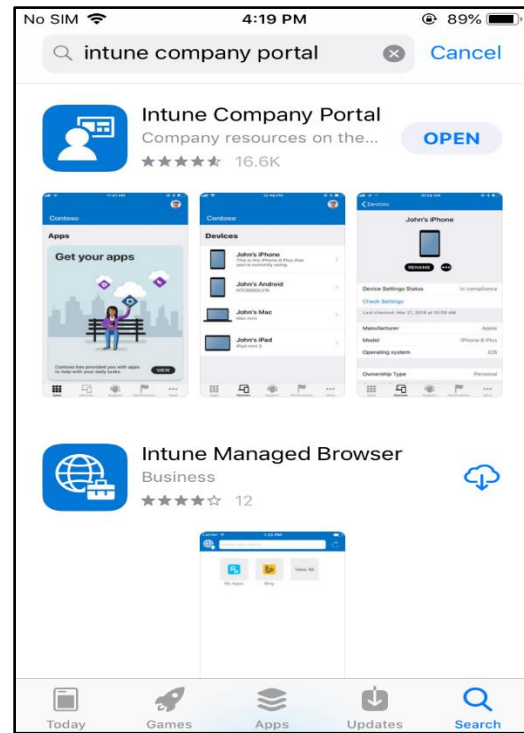
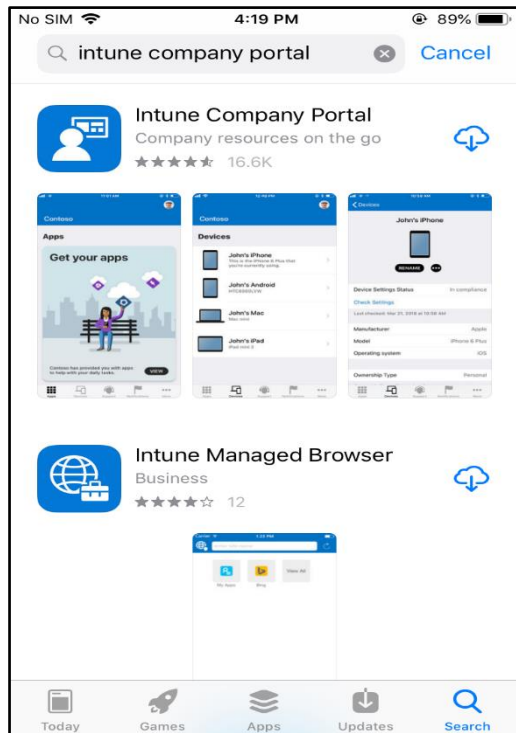

- You will also need to install another app called **Microsoft Authenticator**.

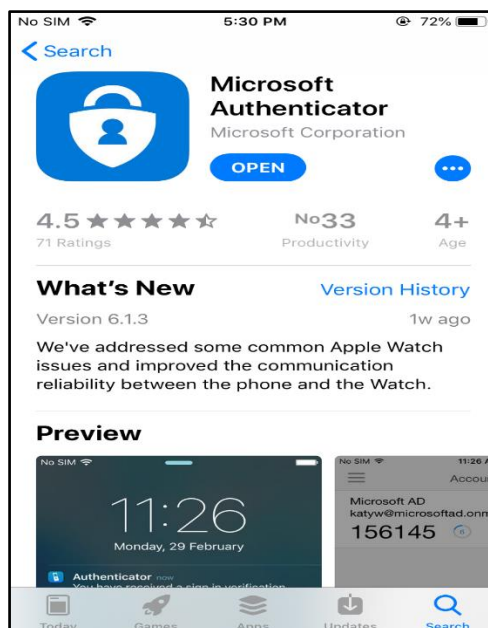

- Now open Intune Company Portal app, enter your RIL Domain ID (**DomainID@ril.com**) and click on **Next**.
(E.g. If your domain ID is rahul1.patil then enter credential “rahul1.patil@ril.com”)
- Enter your Domain password and click on **Sign in** to continue.

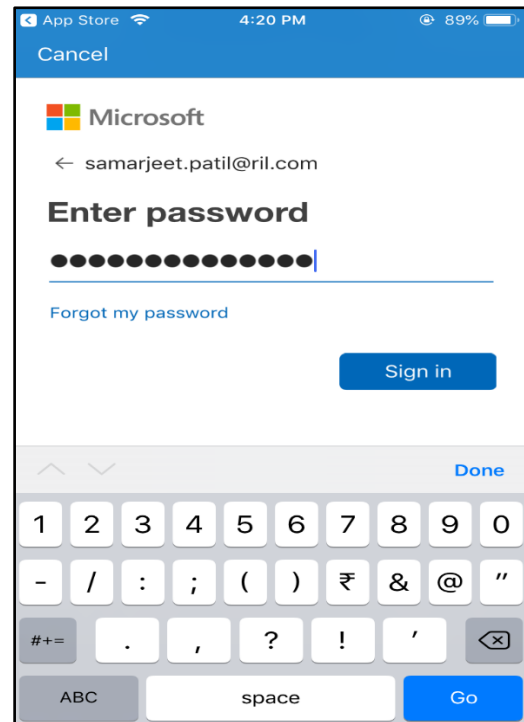
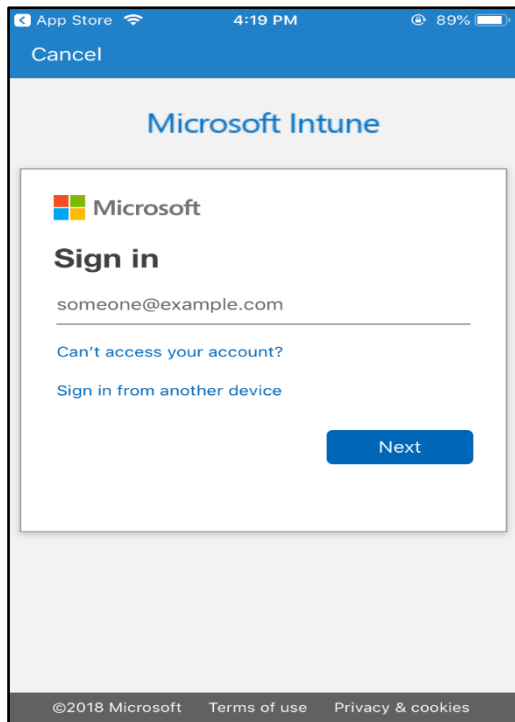

- On the Company Access Setup page, tap **Continue**.
- Click on **Begin** to proceed further

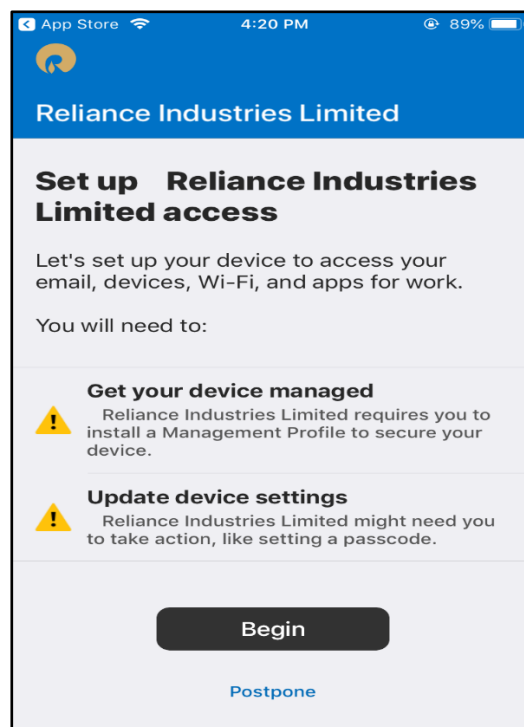
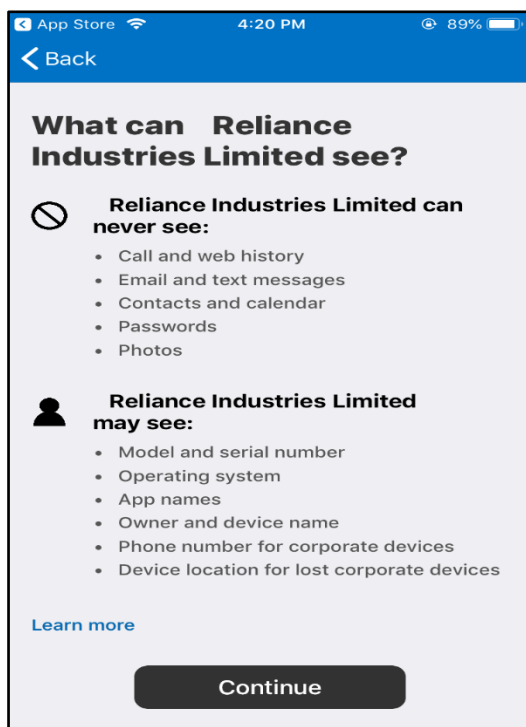

- Click on **Continue** to allow redirection.
- Follow the screens to successfully complete Company portal enrollment.

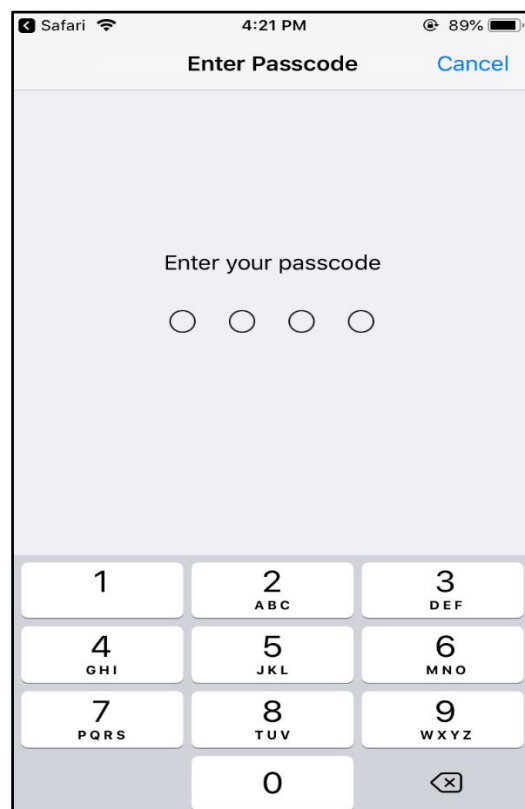
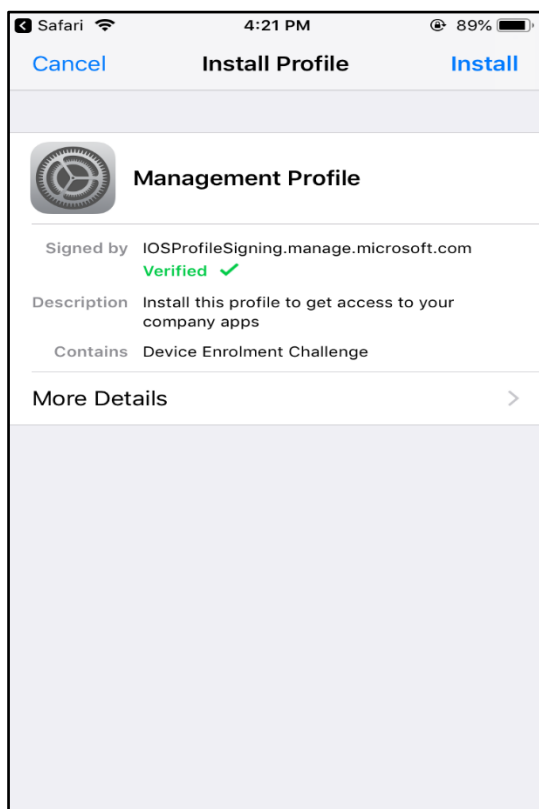
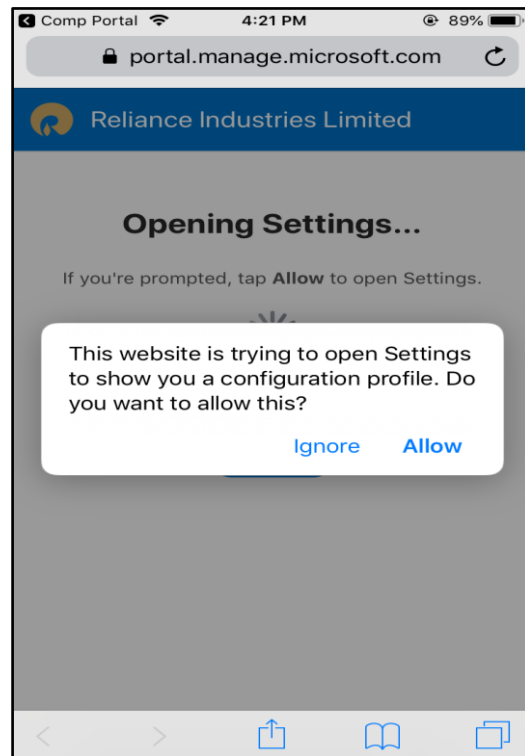
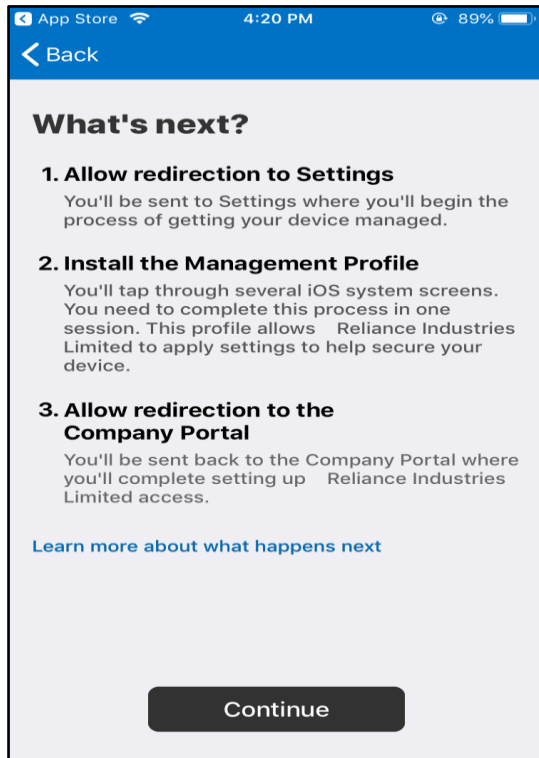

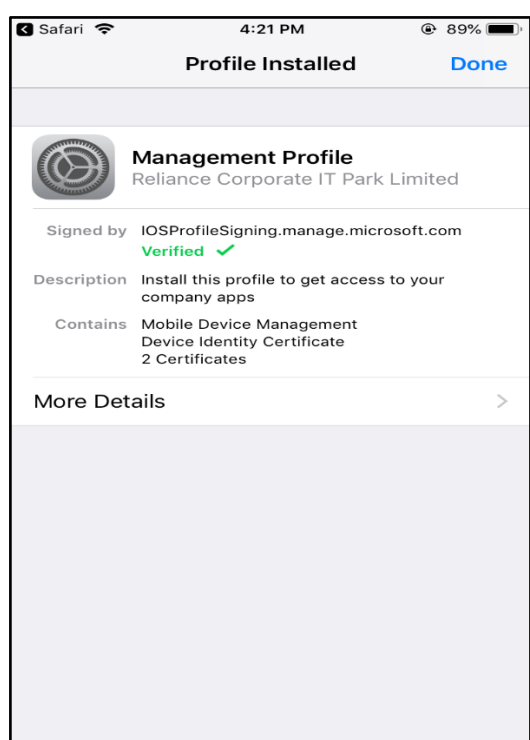
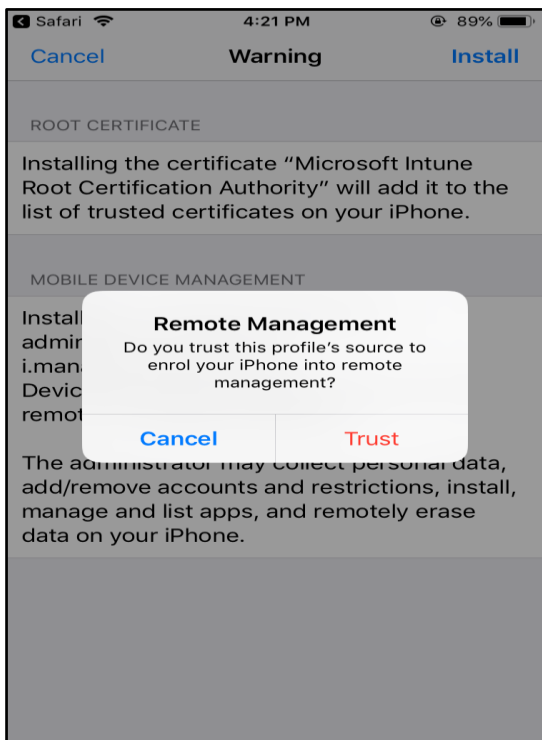
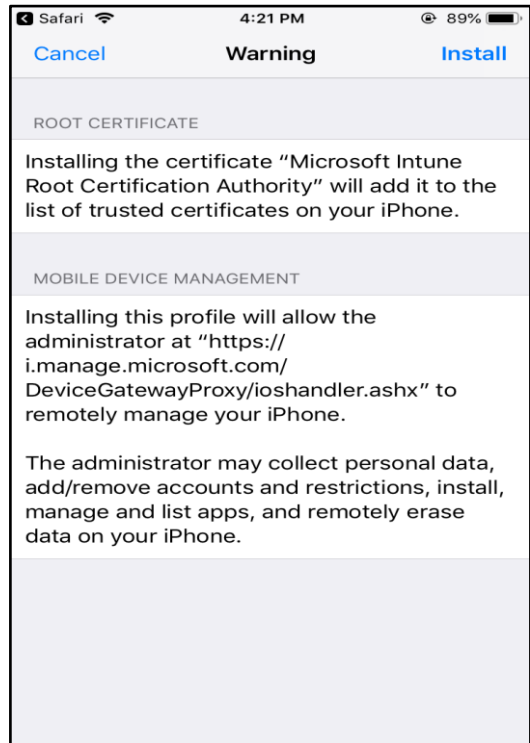
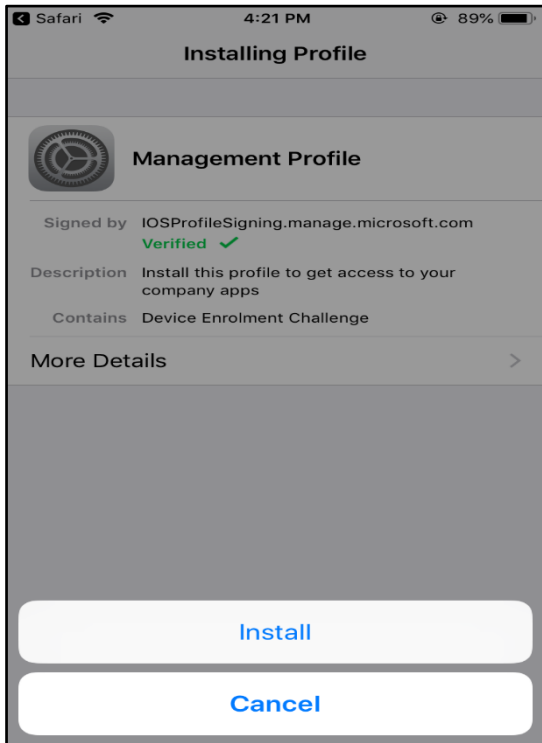

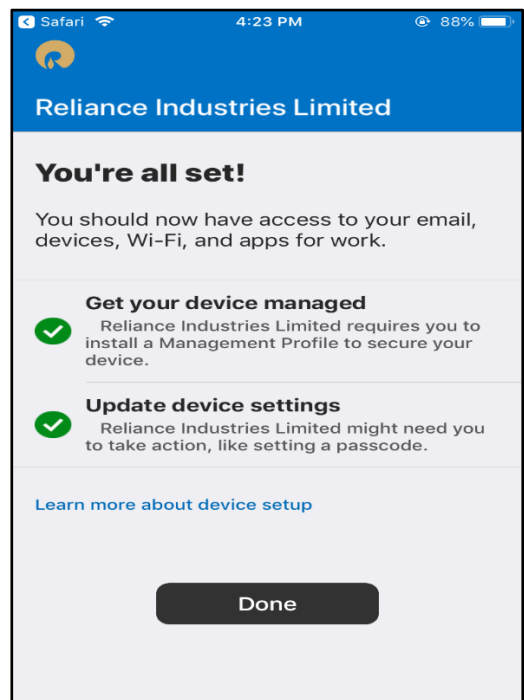
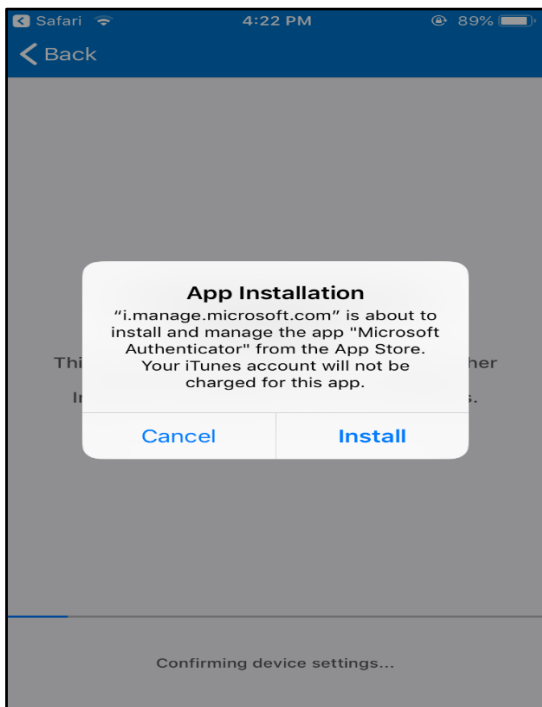
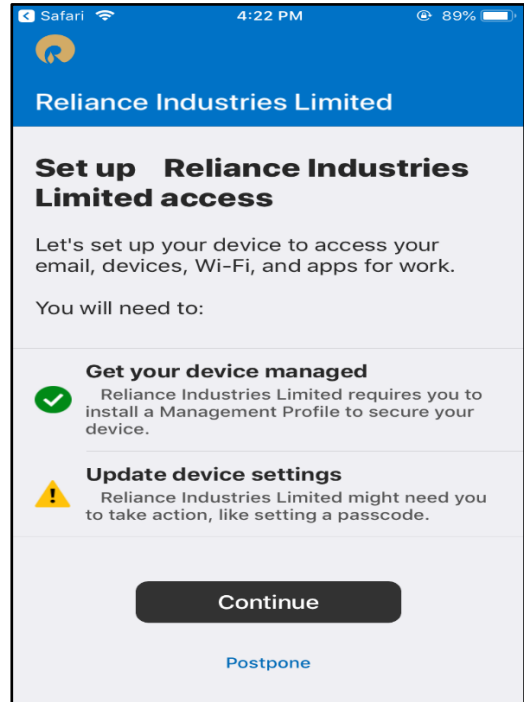
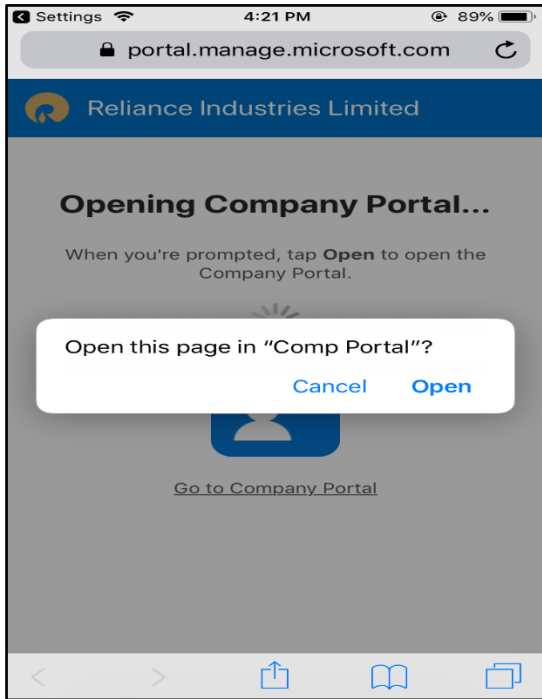

- Click on **View** to see all the Line-of-Business applications

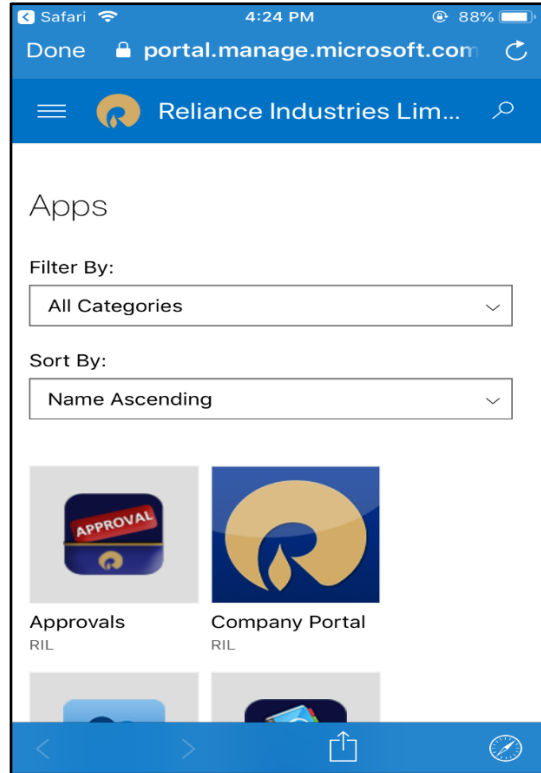
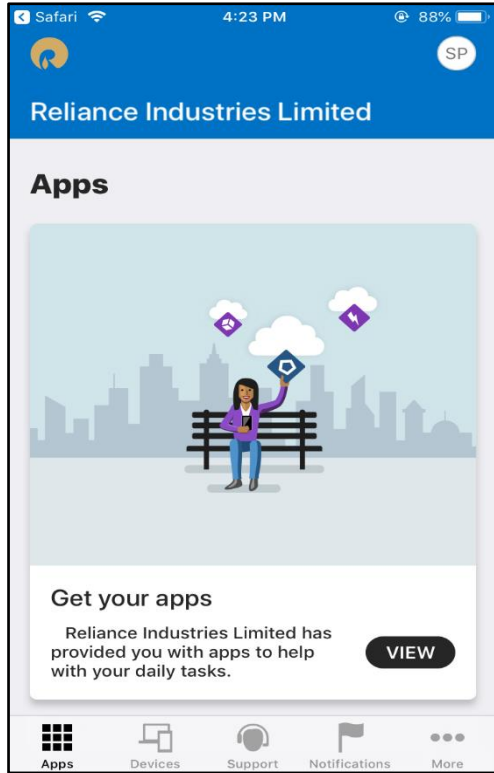

4. Install and Configure Outlook Application.

- Open Company Portal App and install Microsoft Outlook

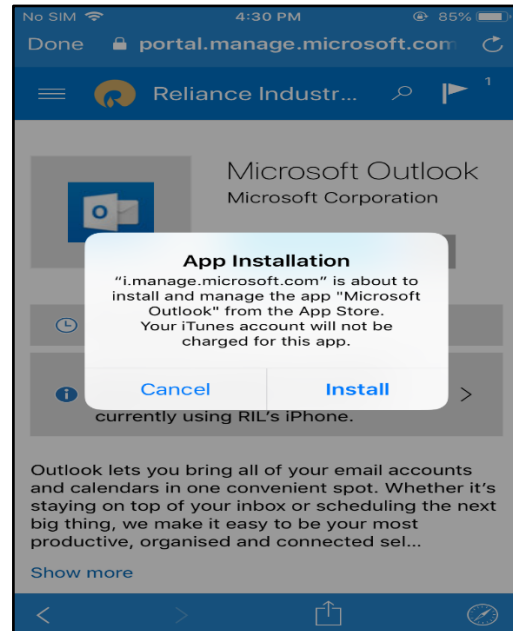
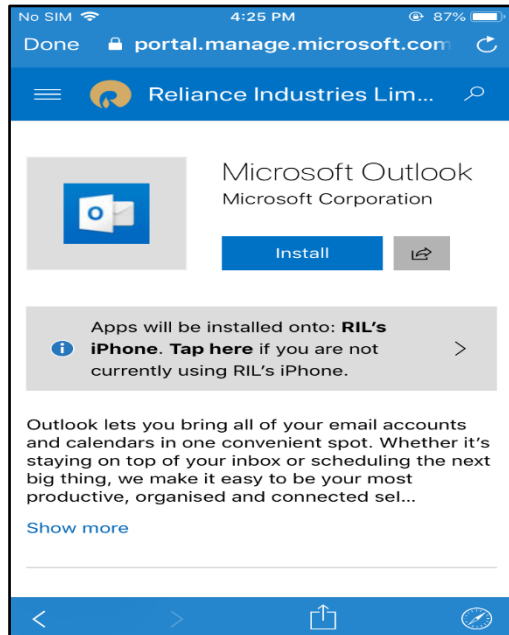

- If any previously configured email account found in Outlook then, kindly uncheck the same and **Skip**.
- Enter your email ID (**firstname.lastname@ril.com**) and click on **Add Account**.

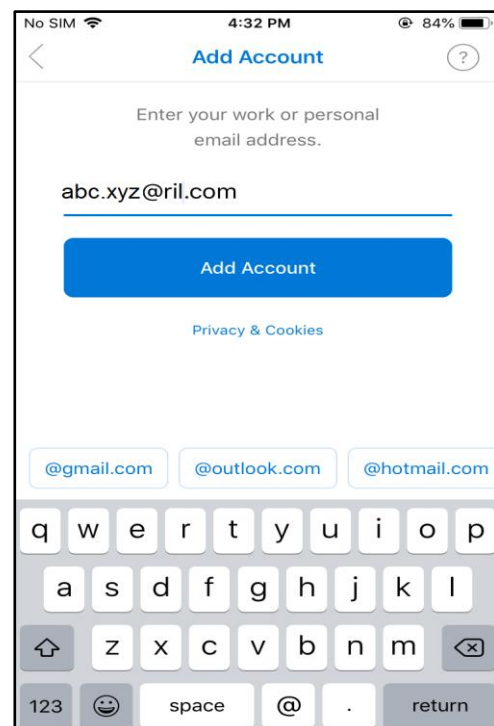
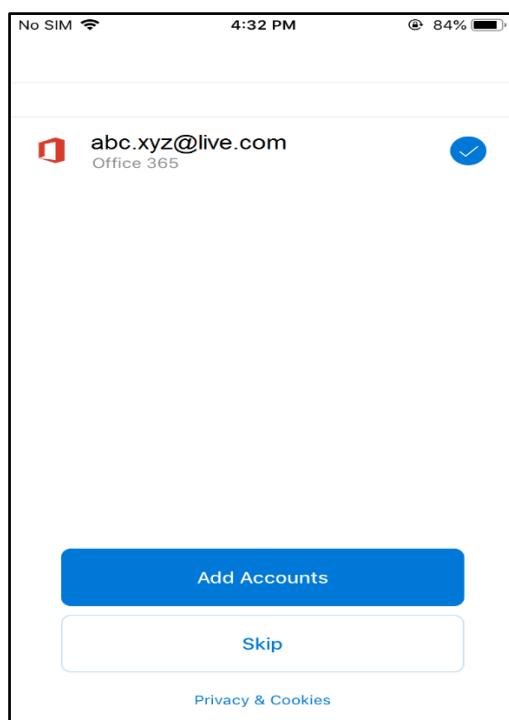

- Click on **Open Authenticator** and select **Allow**

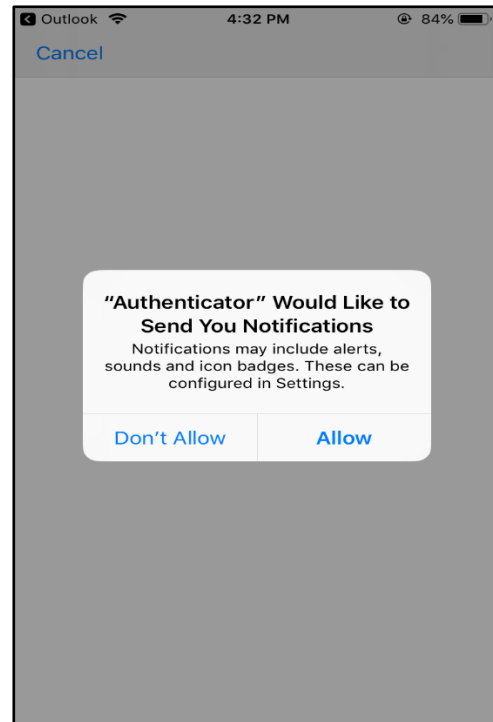
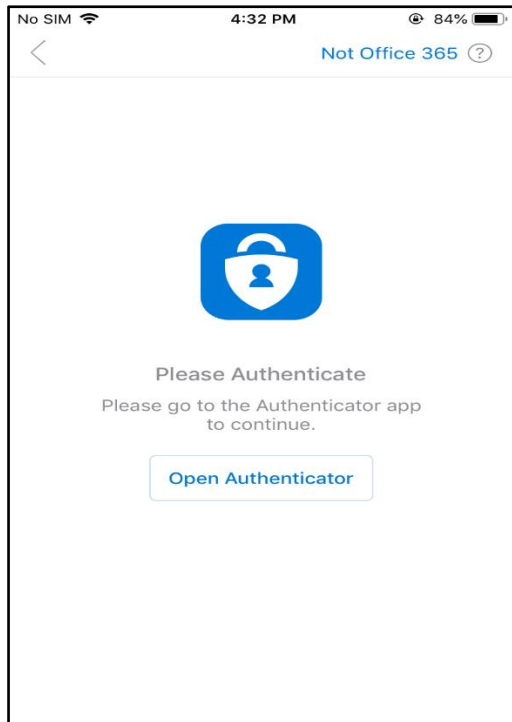

- Click **OK** and **Open** the Microsoft Authenticator App
- Enter your domain password and click on **Sign in**

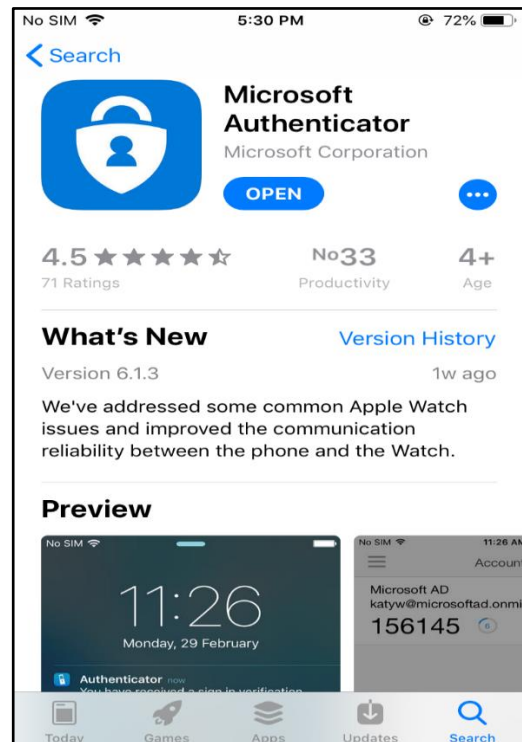
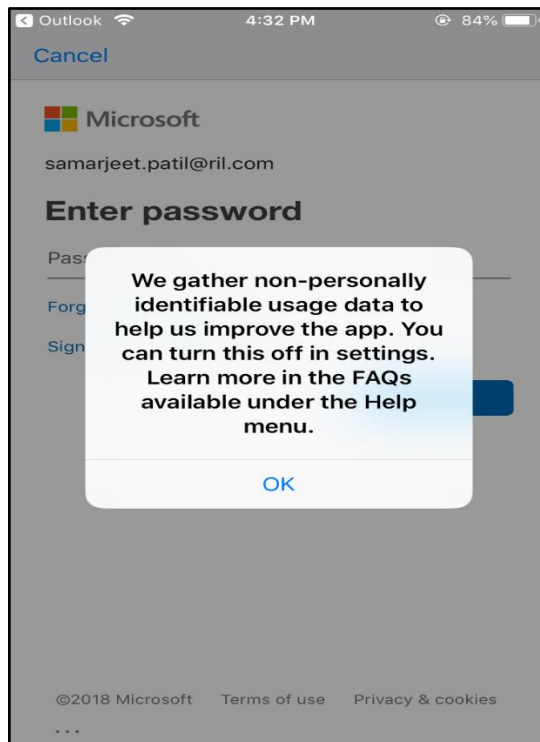

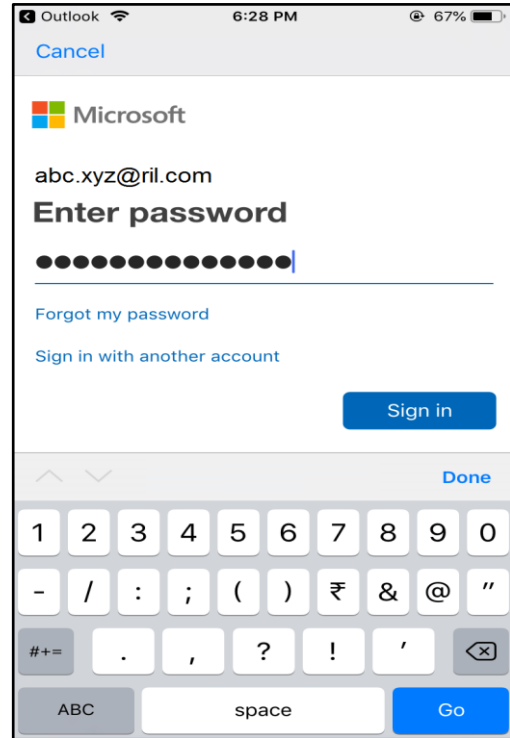
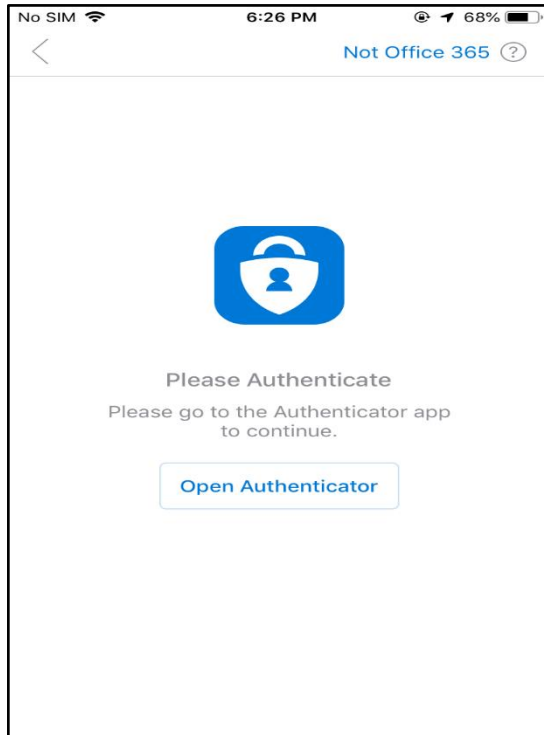

- Outlook will ask to configure any additional personal accounts. If yes click on **Let's do it!** or skip by selecting **Maybe Later**.
- Click on **Turn On** and **Allow** to receive Email and other related notifications.

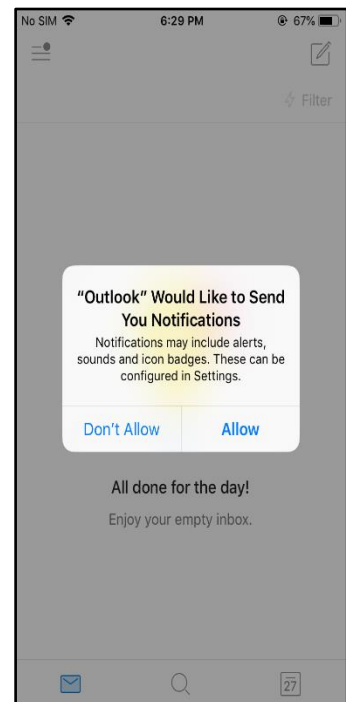
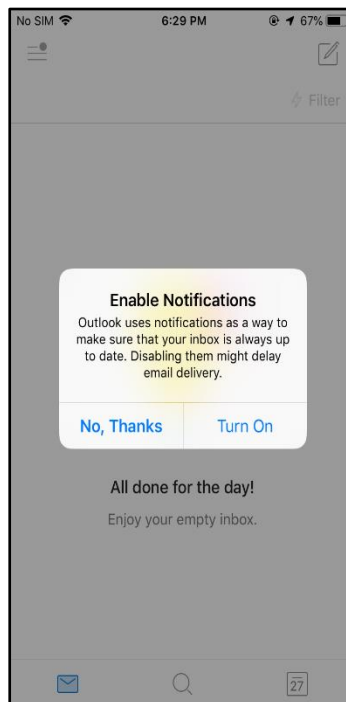
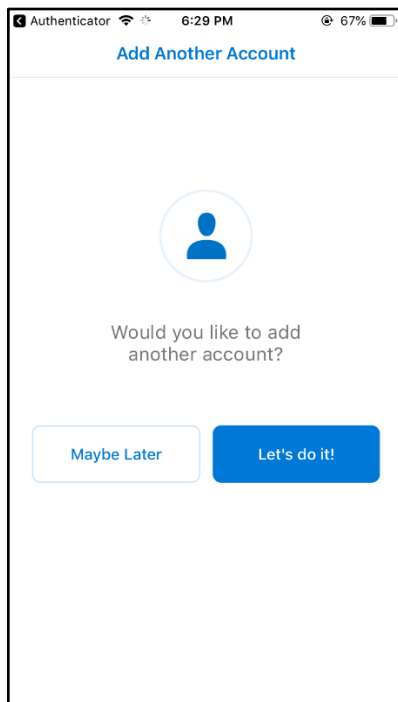

- Your RIL email account is now configured in MS Outlook and mails will auto populate in a couple of minutes.

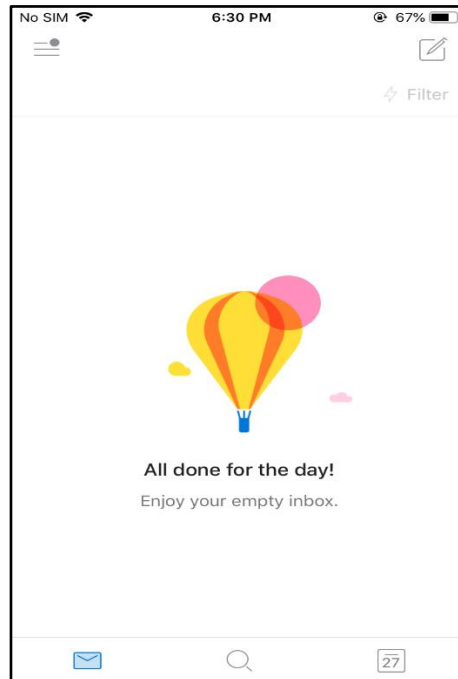

- Tap on ok to continue, later you will be prompted to set a complex 4-digit passcode (**you need to remember this code**).

(Eg: It will not accept simple 4-digit pin like 1111/6543, you need to set a complex 4-digit pin like 2361/4357)

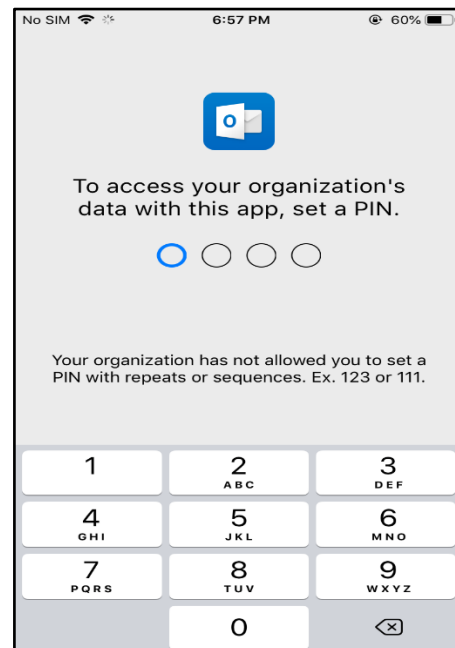
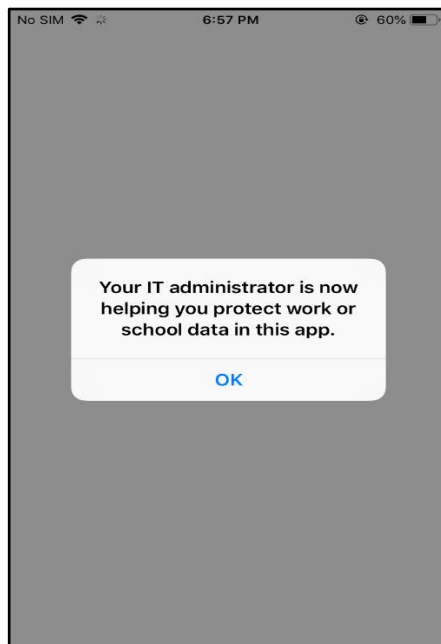

5. To open attachments download the following apps on mobile and sign-in to these apps using your corporate ID

(For additional info refer point 7).

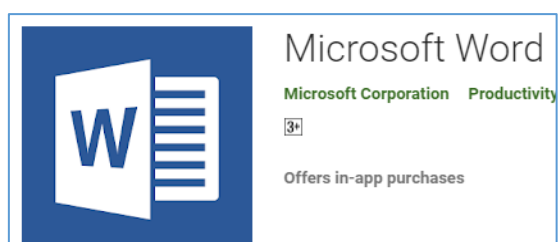
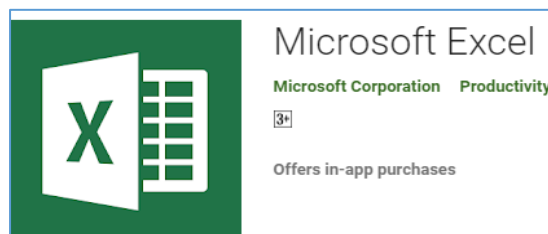
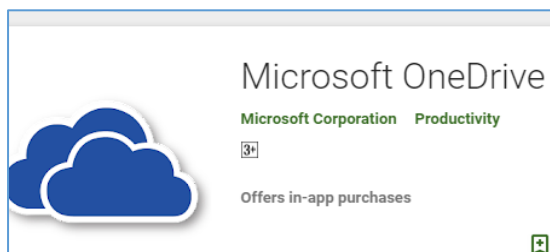

Note: If you have **Word** or **Excel** apps already installed, please ensure you sign-out and sign-in with your corporate ID again.

6. Preferred Intune managed apps

- Microsoft Outlook – For Enterprise mail
- Microsoft OneDrive – cloud storage per user
- Microsoft OneNote- take down minutes of meetings
- Microsoft Excel – viewing and creating spreadsheets/workbooks/csv
- Microsoft Word – viewing and creating documents
- Microsoft PowerPoint - viewing and creating Presentations
- Microsoft SharePoint – to access SharePoint sites.
- Microsoft Skype for Business – IM, Audio calls, conference calls etc.
- Microsoft Teams – for team chat/meeting/Audio and video calls/ collaboration etc.
- Azure Information Protection – for protected files.